

**uni-cart**

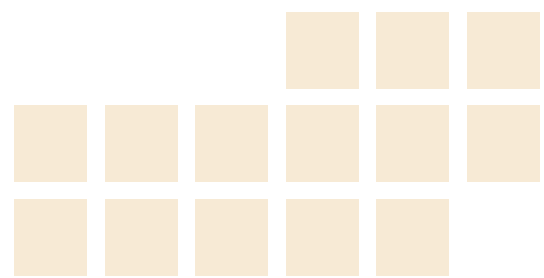

uni-cart



# THE RIGHT CHOICE WHERE SPACE IS AT A PREMIUM



**uni-cart** masters the challenge of restricted space and difficult conditions. Optimum integration of small medical instruments enables the single-column cart to deliver the solution for flexible applications and fast mobile deployment. **uni-cart** offers lots of convenience with cabling routed in the support column. The stabilizers with individual adaptation of length offer a high level of stability.

This compact miracle in space can be used in a wide range of medical

- Anaesthesia
- Endoscopy
- Physiotherapy or
- Ultrasound diagnostics



■ **uni-cart** Application for stress test ECG



■ **uni-cart** Application for flexible endoscopy



■ **uni-cart** Modular solution to provide a mobile source of power supplied by lithium ion batteries



■ **uni-cart** Multiple measurement station (resting ECG / lung function)

Technical data

from page 18

Order configurations **uni-cart**

from page 22

# uni-cart – THE HIGHLIGHTS AT A GLANCE



The **patented base design** from **uni-cart** facilitates **space-saving adaptation of the platform work area** in the 4-stabilizer and ...



... in the 5-stabilizers variants to match the size of the instruments.

## Perfect functionality

- The adjustable-length stabilisers ensure great stability and versatility:
- The 4-stabilizer version offers the greatest stability when parts of the superstructure protrude.
- If the centre of gravity is located in the middle of the truck, the 5-stabilizer model offers the requisite safety.
- **uni-cart** carries payloads of up to 65 kg /143 lbs despite its small foot print.

## Safe power supply

- Socket strips fit easily in the power column. Wiring is safe and concealed.
- Wires emerging from the truck are prevented from being pulled out by a cable anchor incorporated into the base.

## Consistent ergonomic design

- Twin swivel castors (Ø 75 mm or Ø 100 mm) ensure optimum riding quality and ease of manoeuvre. Handles attached to the front or back enable control.
- The **uni-cart** features mechanically or electrically operated height adjustments, thus enabling the equipment operator either to sit or to stand while working.



**Socket strips** can be fastened to the bearing column, which houses **concealed wiring**.



Monitors can be installed on various available types of swivel-mounted or tiltable platforms, such as the VESA 75 / 100 adaption.



The **isolating transformer** is integrated between the stabilizers to save space and is covered by an additional shelf.

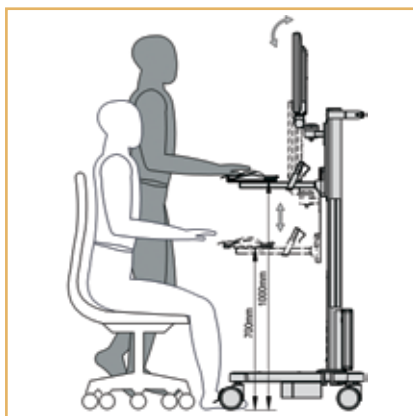

Nimble and readily adaptable to new situations: the **uni-cart with built-in height adjustments**.



# uni-cart – INGENUOUSLY DESIGNED BASE AND BEARING COLUMN

The **uni-cart** is equipped with a single column. Its unique traits are the sophisticated design of its base and its patented undercarriage. Its qualities can be summarised under the following headings:

- 1** The 4-stabiliser version is specially designed for configurations involving protruding elements, such as bottom storage shelves. If the centre of gravity is located in the middle of the truck, the 5-stabilizer model offers the requisite safety.
- 2** The adjustable length of the stabilisers ensures remarkable steadiness together with great versatility, thus permitting a variety of applications tailored to the user's needs.
- 3** Additional stability can be obtained by installing optional counter weights either beneath the base or in the frontally protruding portions.
- 4** The **uni-cart** affords economical transport (small package) thanks to its stabilisers, which can be mounted with ease onsite.
- 5** Thanks to its lightweight construction and smoothly rolling twin swivel castors, the equipment trolley provides swift transport to the place of its deployment.
- 6** The low profile of the undercarriage allows its stabilisers to fit beneath a nearby desk.

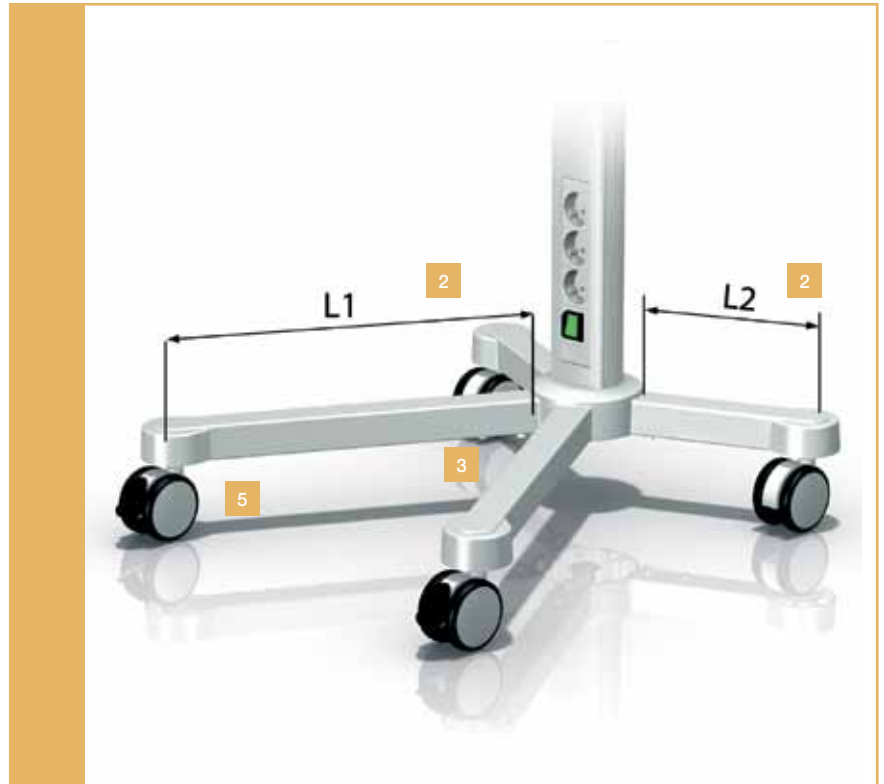

**uni-cart** with 4 adaptable stabilizers for projecting system elements.



The **uni-cart** basic frame with 5 stabilizers for centrally positioned payloads.



The **uni-cart's** support extrusion likewise fulfils every demand that can be made of a mobile equipment carrier and enables remarkably varied applications. They can be summarised under the following points:

- 1 Data lines and power feed lines, as well as any excess cable, can be stowed where they are both well protected and inconspicuous.
- 2 A variety of domestic and foreign-model socket strips fit easily inside.
- 3 Cover strips enable swift and unhampered access while keeping dirt at bay. These strips cover the T-slots and protect the interior of the support extrusion.
- 4 The bearing column likewise affords space for attaching a monitor holder or an IV pole.
- 5 Two tapped strips along the bearing column enable attachment of additional vehicle components.
- 6 The smooth surfaces enable fast and effective cleaning and disinfection.
- 7 In order to prevent wires emerging from the truck from being suddenly tugged out, they are secured by a cable anchor incorporated into the truck base.

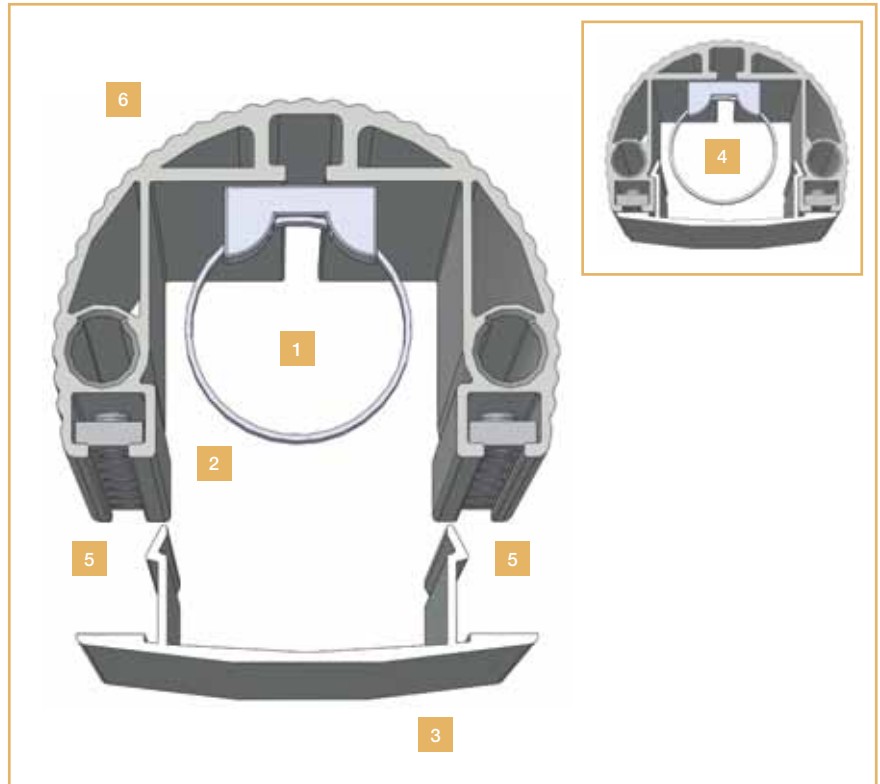

Cross section: the support extrusion of the **uni-cart**.



A sturdy cable anchor and optional counterweights afford comprehensive protection against mishaps.



# DESIGN ELEMENTS AND DIMENSIONS

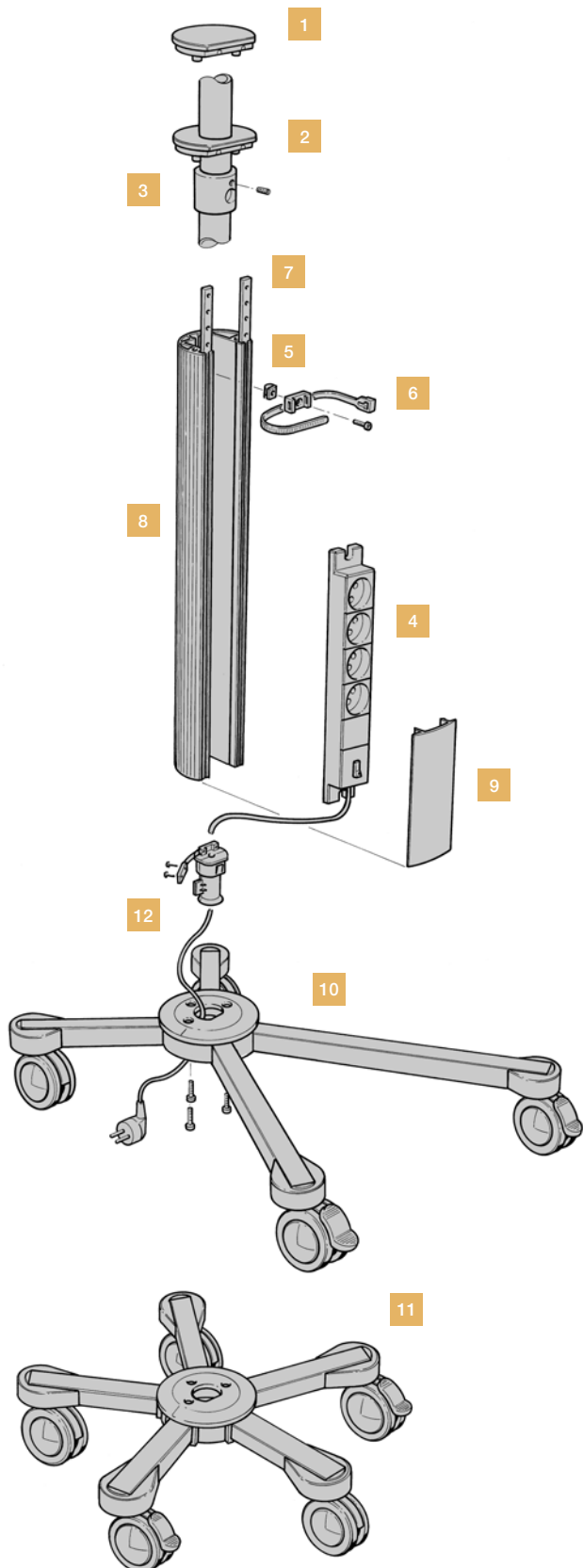

- 1 Cap made of plastic (ABS)
- 2 Cap made of plastic (ABS) with hole, used with accessories (e. g. suction systems, IV pole etc.)
- 3 Mounting for a bar (Ø 25 mm), e. g. from an IV pole
- 4 Socket strip, variable mounting in the rear T-slots of the support column
- 5 Spring nuts M5 or M6
- 6 Cable tie
- 7 Tapped strip (made of steel, zinc-plated), for mounting all system components on the support column (tapped hole M6 in increments of 32 mm)
- 8 Support column (made of extruded aluminium), powder-coated
- 9 Cover strips (made of plastic), for closing the installation space in the support column between the system elements
- 10 A base with 4 stabilizers (zinc-plated and powder-coated) as well as a powder-coated aluminium pressure die cast node point
- 11 A base with 5 stabilizers (zinc-plated and powder-coated) as well as a powder-coated aluminium pressure die cast node point
- 12 Cable strain relief (made of plastic)

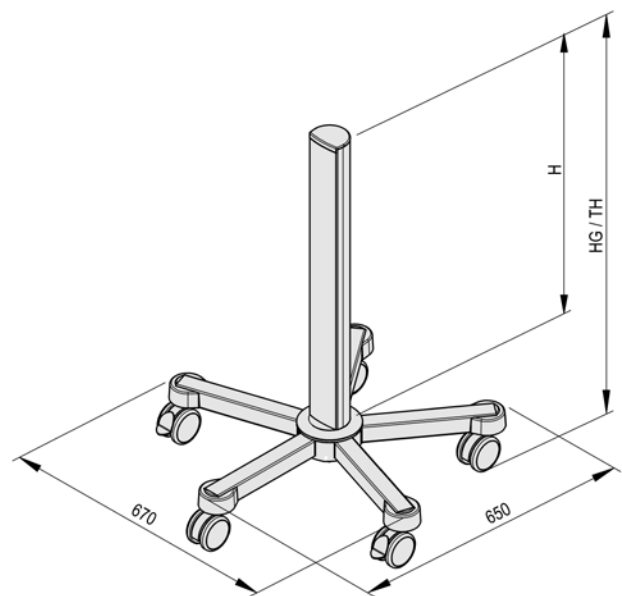
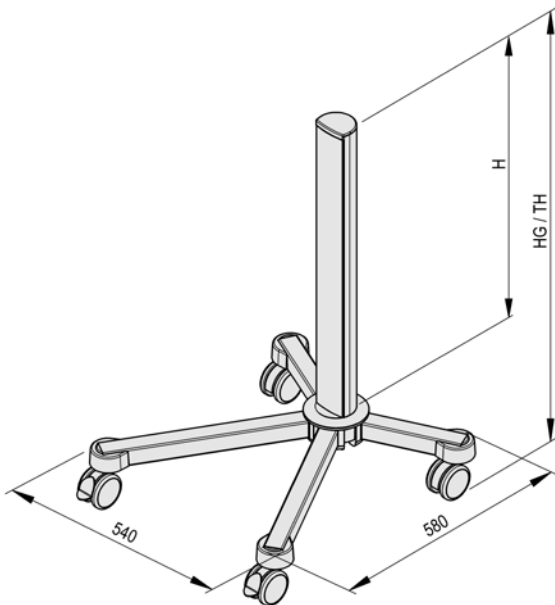

Length of the extrusion H	Installation height H (in units)	Total height TH for castors Ø 75 mm	Total height TH for castors Ø 100 mm
680 mm	21 U <sup>1)</sup>	820 mm	857 mm
968 mm	30 U <sup>1)</sup>	---	1145 mm
1128 mm	35 U <sup>1)</sup>	---	1305 mm

## Setup basic frame

- 1 base with 4 or 5 stabilizers
- 4 or 5 twin swivel castors with Ø 75 mm or Ø 100 mm, 2 with wheel locks (also supplied in conductive version)
- 1 support column with 2 tapped strips
- Supplied partly assembled (optional: supplied fully assembled)

## Load capacities

- Basic frame (total payload)
  - with 4 stabilizers 65 kg / 143 lbs
  - with 5 stabilizers 50 kg / 110 lbs
- Shelf 10 kg / 22 lbs
- Block of drawer
  - shelf 10 kg / 22 lbs
  - drawer 3 kg / 6.6 lbs

# MODULARITY FOR NUMEROUS CONFIGURATION OPTIONS

The modular structure is the defining feature of the **uni-cart** mobile single-column equipment carts and the entire ITD product range, which allows all support systems to be configured, customised, upgraded or easily modified for special functions and application areas using the extensive standard range. This capability allows users to react fast and consistently to any changes or new customer requirements. The T-slots on the support extrusion or special devices ensure easy assembly of the components. The display presented alongside shows a small selection of accessories for the **uni-cart** equipment carts.



**Endoscop holders or IV poles** can be mounted in the support column or on the shelf.



**Cabling** to equipment is routed in the support column.





**Shelves and drawers** are available in different versions. The colour of corners and handles can be matched to instrumentation or CI livery.

An **optional handle** can be attached to the equipment truck to improve its manoeuvrability. Moreover, the handle is decorative.



Monitors of different sizes weighing up to 14 kg / 30.8 lbs overall can be installed by attaching various fixtures.

# ORDER CONFIGURATIONS



## uni-cart basic version

Order number: RS.4801.XXX <sup>2)</sup>

Equipment cart, 21 U <sup>1)</sup> (total height: 820 mm), fitted with:

- 1 basic frame with 4 twin swivel castors, Ø 75 mm, 2 with wheel locks
- 1 block of drawers with handle (front)
- 1 cover strip and cap
- 1 integrated cable strain relief

**Load capacity:** 65 kg / 143 lbs

### Finish:

- RAL 7035 light grey, powder-coated
- **Handle and corners** (see <sup>2)</sup>)

## uni-cart basic version

Order number: RS.4111.XXX <sup>2)</sup>

Equipment cart, 30 U <sup>1)</sup> (total height: 1145 mm), fitted with:

- 1 basic frame with 4 twin swivel castors, Ø 100 mm, 2 with wheel locks
- 1 block of drawers with handle (front)
- 1 shelf
- 1 socket strip, earthed, 3-way, with on and off switch
- 1 cover strip and cap
- 1 integrated cable strain relief

**Load capacity:** 65 kg / 143 lbs

### Finish:

- RAL 7035 light grey, powder-coated
- **Handle and corners** (see <sup>2)</sup>)

<sup>1)</sup> 1 U = 32 mm

<sup>2)</sup> Trim colour: make sure you replace .XXX with .901 = RAL 5021 water blue, .902 = RAL 5013 cobalt blue, .903 = RAL 7035 light grey



## uni-cart Rollstand for Philips IntelliVue MP5-70 / MX600-800

Order number: RS.4903.801

Equipment cart, 32 U <sup>1)</sup> (total height: 1265 mm),  
fitted with:

- 1 basic frame with 5 twin swivel castors, Ø 100 mm,  
2 with wheel locks
- 1 tilt and swivel Quickmount unit for Philips  
IntelliVue MP5-70 / MX600-800 up to 14 kg / 30.8 lbs
- 1 vertical holder for „external rack“
- 1 storage basket
- 1 push handle, rear
- 1 cover strip and cap
- 1 integrated cable strain relief

**Load capacity:** 50 kg / 110 lbs

**Finish:**

- RAL 7035 light grey, powder-coated
- **Handle** and **holder:** Medium Aqua Accent

# ORDER CONFIGURATIONS



## uni-cart with electrical height adjustment

Order number: RS.4145.XXX <sup>2)</sup> (with 230 V input voltage)  
RS.4146.XXX <sup>2)</sup> (with 110 V input voltage)

Equipment cart, 35 U <sup>1)</sup> (total height: 1305 mm),  
fitted with:

- 1 basic frame with 4 twin swivel castors, Ø 100 mm, 2 with wheel locks
- 1 electrical height adjustment with power pack (input: 110 V / 230 V and 50 / 60 Hz)
- 1 remote control for the height adjustment
- 1 monitor holder, universal, with VESA 75 / 100 adaption up to 14 kg / 30.8 lbs
- 1 keyboard drawer with pull-out mousepad (left / right)
- 1 EURO socket strip, 3-way, with on and off switch
- 1 push handle, rear
- 1 PC / computer holder (small), rear
- 1 connecting cable, earthed, length 5 m
- 2 cable winders, rear
- 1 integrated cable strain relief
- For mounting flat screens and keyboard (height adjustable as a unit; for a range of 300 mm)
- Optimum position of the keyboard to the screen
- Deployable as sit / stand workstation (at the touch of a button)

**Load capacity:** 65 kg / 143 lbs

**Finish:**

- RAL 7035 light grey, powder-coated
- **Handle** (see <sup>2)</sup>)

**Payload:**

- electrical height adjustment: up to 20 kg / 44 lbs





## uni-cart with electrical height adjustment

Order number: RS.4147.XXX <sup>2)</sup> (with 230 V input voltage)  
RS.4148.XXX <sup>2)</sup> (with 110 V input voltage)

Equipment cart, 35 U <sup>1)</sup> (total height: 1305 mm),  
fitted with:

- 1 basic frame with 4 twin swivel castors, Ø 100 mm, 2 with wheel locks
- 1 electrical height adjustment with power pack (input: 110 V / 230 V and 50 / 60 Hz)
- 1 remote control for the height adjustment
- 1 monitor holder, universal, with VESA 75 / 100 adaption up to 14 kg / 30.8 lbs
- 1 keyboard drawer with pull-out mousepad (left / right)
- 1 push handle, rear
- 1 connecting cable, earthed, length 5 m
- 2 cable winders, rear
- 1 integrated cable strain relief
- For mounting flat screens and keyboard (height adjustable as a unit; for a range of 300 mm)
- Optimum position of the keyboard to the screen
- Deployable as sit / stand workstation (at the touch of a button)

**Load capacity:** 65 kg / 143 lbs

**Finish:**

- RAL 7035 light grey, powder-coated
- **Handle** (see <sup>2)</sup>)

**Payload:**

- electrical height adjustment: up to 20 kg / 44 lbs

# ORDER CONFIGURATIONS

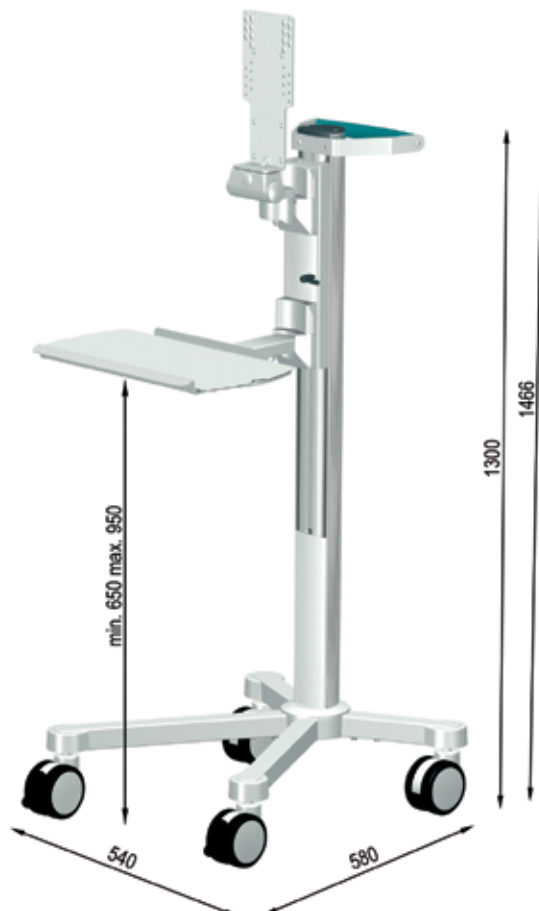

## uni-cart with mechanical height adjustment

Order number: RS.4910.XXX <sup>2)</sup> (payload: 3-10 kg / 6.6-22 lbs)  
RS.4911.XXX <sup>2)</sup> (payload: 10-16 kg / 22-35.2 lbs)

Equipment cart, 35 U <sup>1)</sup> (total height: 1305 mm),  
fitted with:

- 1 basic frame with 4 twin swivel castors, Ø 100 mm, 2 with wheel locks
- 1 mechanical height adjustment
- 1 monitor holder, universal, with VESA 75 / 100 adaption up to 14 kg / 30.8 lbs
- 1 keyboard drawer with pull-out mousepad (left / right)
- 1 push handle, rear
- 1 integrated cable strain relief
- For mounting flat screens and keyboard (height adjustable as a unit; can be fixed in place with a clamp lever mounted as an attachment)
- Optimum position of the keyboard to the screen
- Deployable as sit / stand workstation (for a range of 300 mm)

**Load capacity:** 65 kg / 143 lbs

**Finish:**

- RAL 7035 light grey, powder-coated
- **Handle** (see <sup>2)</sup>)

**Payload:**

- mechanical height adjustment: up to 16 kg / 35.2 lbs



## uni-cart with mechanical height adjustment and laptop holder

Order number: RS.4907.991 <sup>1)</sup> (payload: 3-10 kg / 6.6-22 lbs)

Equipment cart, 35 U <sup>1)</sup> (total height: 1305 mm), fitted with:

- 1 basic frame with 4 twin swivel castors, Ø 100 mm, 2 with wheel locks
- 1 mechanical height adjustment
- 1 laptop holder
- 1 integrated cable strain relief
- For receiving standard laptops (proper attachment via mounted clamp levers)
- Deployable as sit / stand workstation (for a range of 300 mm)

**Load capacity:** 65 kg / 143 lbs

**Finish:**

- RAL 7035 light grey, powder-coated
- **Handle** (see <sup>2)</sup>)

**Payload:**

- mechanical height adjustment: up to 10 kg / 22 lbs

# OVERVIEW

## SYSTEM COMPONENTS AND ACCESSORIES

Basic frame	Installation height 21 U <sup>1)</sup> 30 U <sup>1)</sup> 35 U <sup>1)</sup>	<u>with 4 stabilizers</u> <b>RS.4008.991</b> <b>RS.4011.991</b> <b>RS.4027.991</b>	<u>with 5 stabilizers</u> <b>RS.5008.991</b> <b>RS.5011.991</b> <b>RS.5027.991</b>
Castor conversion kit	Ø 100 mm instead of standard Ø 75 mm Ø 100 mm, conductive, instead of standard Ø 75 mm Ø 100 mm, conductive, instead of standard Ø 100 mm wall protector	<u>for 4 stabilizers</u> <u>(4-part set)</u> <b>ZV.9920.999</b> <b>ZV.9921.999</b> <b>ZV.9922.999</b> <b>ZV.9964.999</b>	<u>for 5 stabilizers</u> <u>(5-part set)</u> <b>ZV.9926.999</b> <b>ZV.9927.999</b> <b>ZV.9929.999</b> <b>ZV.9995.999</b>
Shelf	with handle (front) with pull-out mousepad (left / right) with handle (front) and pull-out mousepad (left / right)		<b>RS.4360.XXX <sup>2)</sup></b> <b>RS.4361.XXX <sup>2)</sup></b> <b>RS.4370.XXX <sup>2)</sup></b> <b>RS.4372.XXX <sup>2)</sup></b>
Rack base			<b>RS.0143.991</b>
PC / Computer holder	small, up to 5 kg large, up to 20 kg		<b>TS.6144.991</b> <b>TS.6146.991</b>
Power pack holder	universal, small universal, large		<b>TS.0524.991</b> <b>TS.0574.991</b>
Laptop holder	lockable with mousepad		<b>PT.4126.903</b> <b>TS.6301.991</b>
Monitor holder	with VESA 75 / 100 adaption up to 8 kg / 17.6 lbs, in the support column with VESA 75 / 100 adaption up to 8 kg / 17.6 lbs, on the support column with VESA 75 / 100 adaption, universal, up to 14 kg / 30.8 lbs, in the support column with VESA 75 / 100 adaption, universal, up to 14 kg / 30.8 lbs, on the support column with VESA 75 / 100 adaption, adjustable, up to 14 kg / 30.8 lbs, in the support column with universal adapter, up to 14 kg / 30.8 lbs, on the support column with Quickmount unit for Philips IntelliVue (MP5-70 / MX600-800)		<b>RS.0296.991</b> <b>TS.6300.991</b> <b>RS.0396.991</b> <b>TS.6359.991</b> <b>RS.0325.991</b> <b>RS.0109.800</b> <b>RS.0397.991</b>
Adapter plates	for Schiller Argus LCM for Nihon Kohden Life Scope for GE Critikon Pro, Dash, Datex Ohmeda for Nihon Kohden Life Scope BSM		<b>TS.0360.999</b> <b>TS.0576.999</b> <b>TS.0305.999</b> <b>TS.0670.999</b>
Pivot arm	single, with VESA 75 / 100, up to 8 kg / 17.6 lbs		<b>TS.6314.991</b>
Variable height support arm <b>flexion-port</b> (with VESA 75 / 100R adaption)	length 300 mm, load capacity 3-10 kg / 6.6-22 lbs length 300 mm, load capacity 8-14 kg / 17.6-30.8 lbs length 400 mm, load capacity 3-10 kg / 6.6-22 lbs length 400 mm, load capacity 8-14 kg / 17.6-30.8 lbs		<b>HA.2000.XXX <sup>2)</sup></b> <b>HA.2007.XXX <sup>2)</sup></b> <b>HA.2001.XXX <sup>2)</sup></b> <b>HA.2008.XXX <sup>2)</sup></b>
Variable height support arm <b>flexion-port</b> (with VESA 75 / 100 adaption, universal)	length 300 mm, load capacity 3-10 kg / 6.6-22 lbs length 300 mm, load capacity 8-14 kg / 17.6-30.8 lbs length 400 mm, load capacity 3-10 kg / 6.6-22 lbs length 400 mm, load capacity 8-14 kg / 17.6-30.8 lbs		<b>HA.2004.XXX <sup>2)</sup></b> <b>HA.2010.XXX <sup>2)</sup></b> <b>HA.2005.XXX <sup>2)</sup></b> <b>HA.2011.XXX <sup>2)</sup></b>
Handle	for variable height support arm <b>flexion-port</b>		<b>HA.1036.991</b>
Counterweight kit	under the basic frame in the stabilizers (front)		<b>RS.4391.991</b> <b>RS.0344.999</b>
Drawer	with handle (front) with pull-out mousepad (left / right) with handle (front) and pull-out mousepad (left / right) 1 unit, high 2 units, high		<b>RS.4363.XXX <sup>2)</sup></b> <b>RS.4364.XXX <sup>2)</sup></b> <b>RS.4369.XXX <sup>2)</sup></b> <b>RS.4368.XXX <sup>2)</sup></b> <b>RS.4381.XXX <sup>2)</sup></b> <b>RS.4389.XXX <sup>2)</sup></b>
Storage basket	tapered tapered (assembly on the rear section) stainless steel tapered, small		<b>ZV.9967.800</b> <b>ZV.9989.991</b> <b>ZV.9893.999</b> <b>ZV.9892.991</b>

Endoscope holder	single, on shelves / standard runners single, in the support column dual, on shelves / standard runners			GW.0868.991 RS.0119.991 GW.0870.991
Drain glas	on support column on telescopic bar			ZV.9963.999 ZV.9986.999
Connector holder	accommodates up to three endoscope connectors			ZV.9833.999
Rinsing bottle holder				GW.9805.999
Hose holder				GW.9882.999
Camera holder	with clamp			GW.9990.999 GW.9983.991
Gel bottle holder				GW.0800.991
Gas bottle holder	for gas bottles with max. 2 l content for gas bottles with max. 2 l content for gas bottles with 3 / 5 / 10 l content, max. Ø 145 mm			GW.0466.991 RS.0110.991 RS.0111.991
IV pole	4 arm, with one-hand adjustment, 4 x 2 kg			ZV.9881.800
Standard runner	length 162 mm length 390 mm			RS.0132.991 RS.0076.991
Anchor	rigid with rotation unit			ZV.9820.799 TS.6286.991
Clamps	for standard runner, Ø 16 mm for standard runner, Ø 18 mm for shelf, Ø 16 mm for shelf, Ø 18 mm			ZV.9876.999 ZV.9877.999 ZV.9878.999 ZV.9879.999
Rail fastener	for drain glas			ZV.9957.999 ZV.9958.999
Holder for suction system				Ergoline / Strässle RS.0378.991
Adapter piece	Ø 40 mm (outside)	Ø 13 mm (inside) ZV.9776.999	Ø 16 mm (inside) ZV.9830.999	Ø 18 mm (inside) ZV.9831.999
Foot switch cradle				ZV.9991.991
Holder for transducer				RS.0131.991
Equipment fixing				FC.0221.991
Box holder	„Dracula“			ZV.9832.999
Jointed arm	with hose clamps (Ø 16 mm) for small equipment (Ø 18 mm)			ZV.9955.799 ZV.9680.999
Push handle				RS.0160.XXX <sup>2)</sup>
Socket strips	earthed, 3-way British Standard, 3-way, with switch and external ground connection cable French Standard, 3-way, with switch and external ground connection cable			ZV.9844.991 ZV.9758.991 ZV.9848.991
Plug removal barrier				GW.0632.991
Cable winder				RS.0267.991
Power cable for EURO socket strips	earthed Swiss Standard British Standard US Standard	without equipotential bonding cable ZV.9809.799 ZV.9798.799 ZV.9860.799 ZV.9770.799		with equipotential bonding cable ZV.9620.999



<sup>1)</sup> 1 U = 32 mm

<sup>2)</sup> Trim colour: make sure you replace .XXX with .901 = RAL 5021 water blue, .902 = RAL 5013 cobalt blue, .903 = RAL 7035 light grey

# OVERVIEW

## SYSTEM COMPONENTS AND ACCESSORIES

EURO power cable	length 0,6 m length 1,0 m length 1,5 m length 2,0 m length 2,5 m	ZV.9773.799 ZV.9960.799 ZV.9371.799 ZV.9372.799 ZV.9373.799
Adapter cable		ZV.9959.799
Equipotential bonding	panel with 4 equipotential plugs equipotential cable, 0,3 m equipotential cable, 0,5 m equipotential cable, 1,0 m equipotential cable, 1,5 m equipotential cable, 5,0 m	RS.0125.991 ZV.9941.999 ZV.9942.999 ZV.9943.999 ZV.9488.999 ZV.9944.999
Isolating transformer	660 VA (with 4x equipotential bonding plugs)	ZV.9412.999
LED stick	with 2 clips with mounting plate with adhesive socket	ZV.9378.999 ZV.9379.999
Spring nuts	M6 (50 pieces)	ZV.9851.999

You will find a comprehensive description and ordering information on all components in the „**system components and accessories**“ section.

System components and accessories	from page 132
Order number index	from page 262

