

vexio-cart

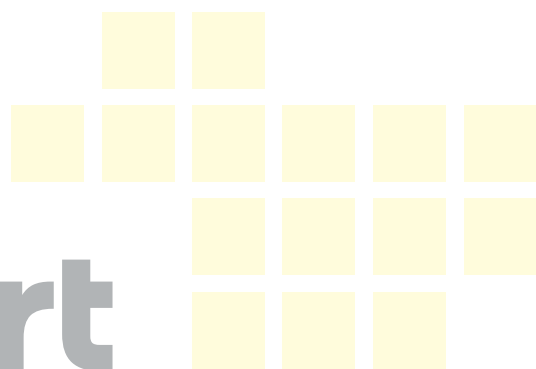

vexio-cart

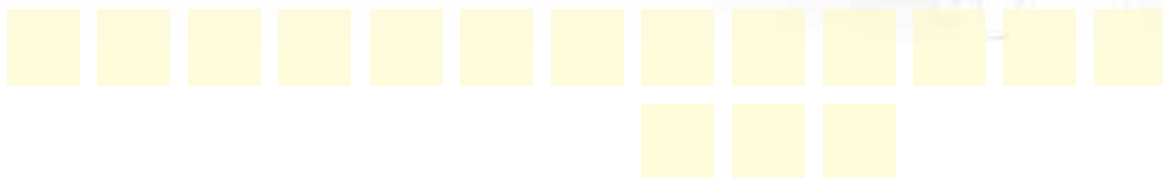

ADJUSTED TO SITUATION AND SPACE

The **vexio-cart** comes in two models: basic and profi, both with an attractive, slender design. Despite the modest size of its footprint it is versatile and its range of uses can be augmented at any time by means of add-ons. A pull-out electrical box located beneath the basic frame or wiring conduits that can be installed on one side offers additional benefits and supports an unobtrusive, safe and sophisticated power supply layout.

The **vexio-cart** can be deployed in virtually all fields of medicine and medical technology, such as, for example, in

- Anaesthesia
- Endoscopy
- Physiotherapy or
- Ultrasound diagnostics





■ **vexio-cart** Application for stress test ECG



■ **vexio-cart** Application for endoscopy



■ **vexio-cart** Variable height PC workstation

Technical data

from page 42

Order configurations **vexio-cart**

from page 46

vexio-cart – THE HIGHLIGHTS AT A GLANCE



Electronic components such as socket strips can be discretely located in the **electrical box**.



A **large useful shelf platform area** (W 400 x D 415 mm) accommodates large-depth units.

Perfect functionality

- The Aluminum construction ensures a payload of up to 65 kg /143 lbs and high load-bearing capacity despite its low weight.
- T-slots on either side of the support column enable variable mounting options.
- The large, smooth-running twin swivel castors provide enhanced mobility and safe running over obstacles.
- When dismantled, **vexio-cart** ensures cost-effective transportation and easy setup on site.

Safe electrical cabling

- Electronic accessories are discretely located in the electrical box integrated below the equipment cart so that assembly points can be easily accessed.
- Electronic components can be accommodated in the electrical tray mounted beneath a shelf.

Smart cable management

- Cable ducts and support extrusions ensure separate and secure routing of data lines and power cables.
- The snap-open mechanism of the cable ducts provides easy access to the cables.
- The cable duct lateral openings provide unimpeded access to cable inlet and outlet in any position along the support extrusion.

Consistent ergonomic design

- Adapted working areas and handle positions allow users to maintain natural body position.
- Large platform areas provide enough space, even for large-depth units.
- A permanent, ergonomically correct working position provides an optional integrated mechanical height adjustment.



Monitor and keyboard holder can be adjusted as a single unit (by 300 mm) with an integrated **mechanical height adjustment**.



Secure electrical cabling is supported by the **electrical tray** mounted beneath a shelf.



A separate and flexible cable routing is ensured by **snap-open cable ducts** with lateral opening slits.



The colour of **design interfaces**, such as handles on the drawers, can be matched to instrumentation or CI livery.



vexio-cart – SMART CABLE MANAGEMENT

The **cable management** is a special feature of the **vexio-cart** single-column equipment cart, which results from the combination of support extrusions, lateral cable ducts and electrical box, which can be summarised as follows:

- 1 A side-fed cable management system enables concealed and protected accommodation of the data lines and power cables.
- 2 A snap-open mechanism with a large opening angle enables a quick and easy access.
- 3 Integrated clamps ensure the neat and separate cable routing and secure closure of the cable ducts.
- 4 The lateral opening slits on the cable ducts allow flexible cable routing and short connection lines for the entire height of the support extrusion.
- 5 The smooth surfaces of the cable ducts ensure quick and neat options for cleaning and disinfection.
- 6 The cable ducts are important design elements which can be matched to instrumentation or CI livery.

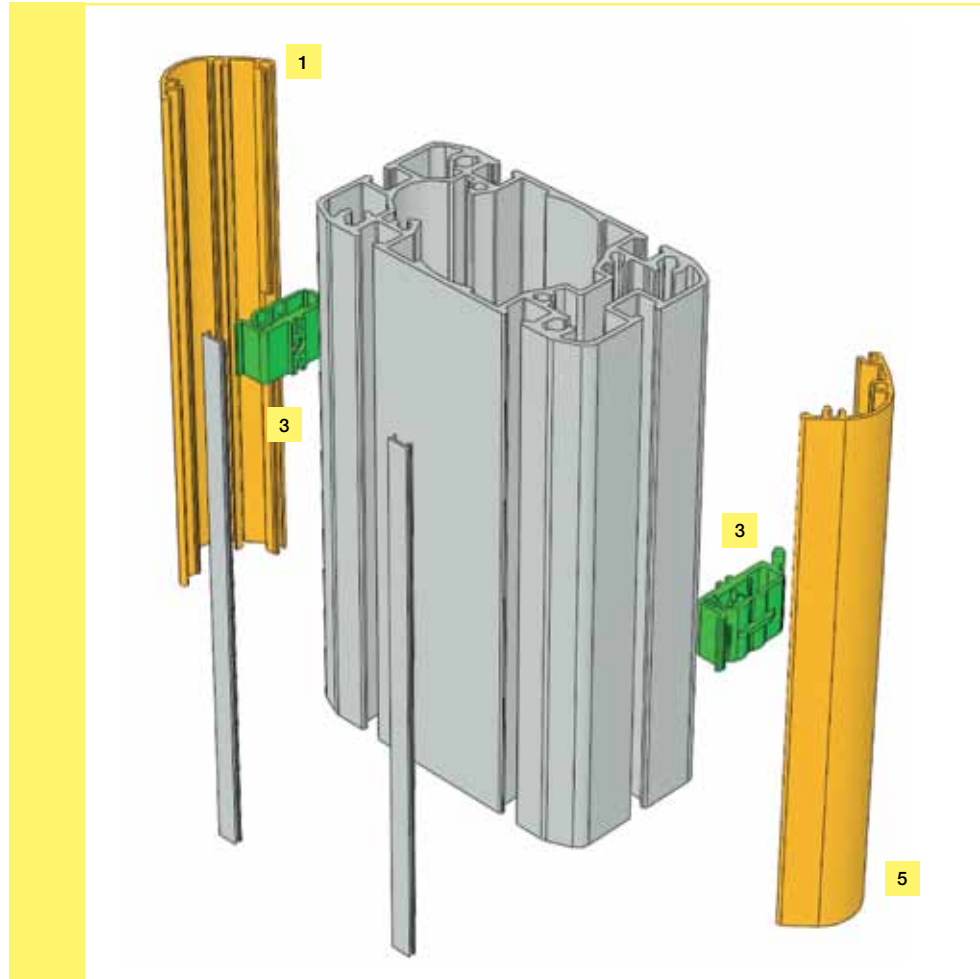

Close-up: the **vexio-cart** support extrusion with cable ducts.



Short connection lines from the cable ducts to the item of equipment.

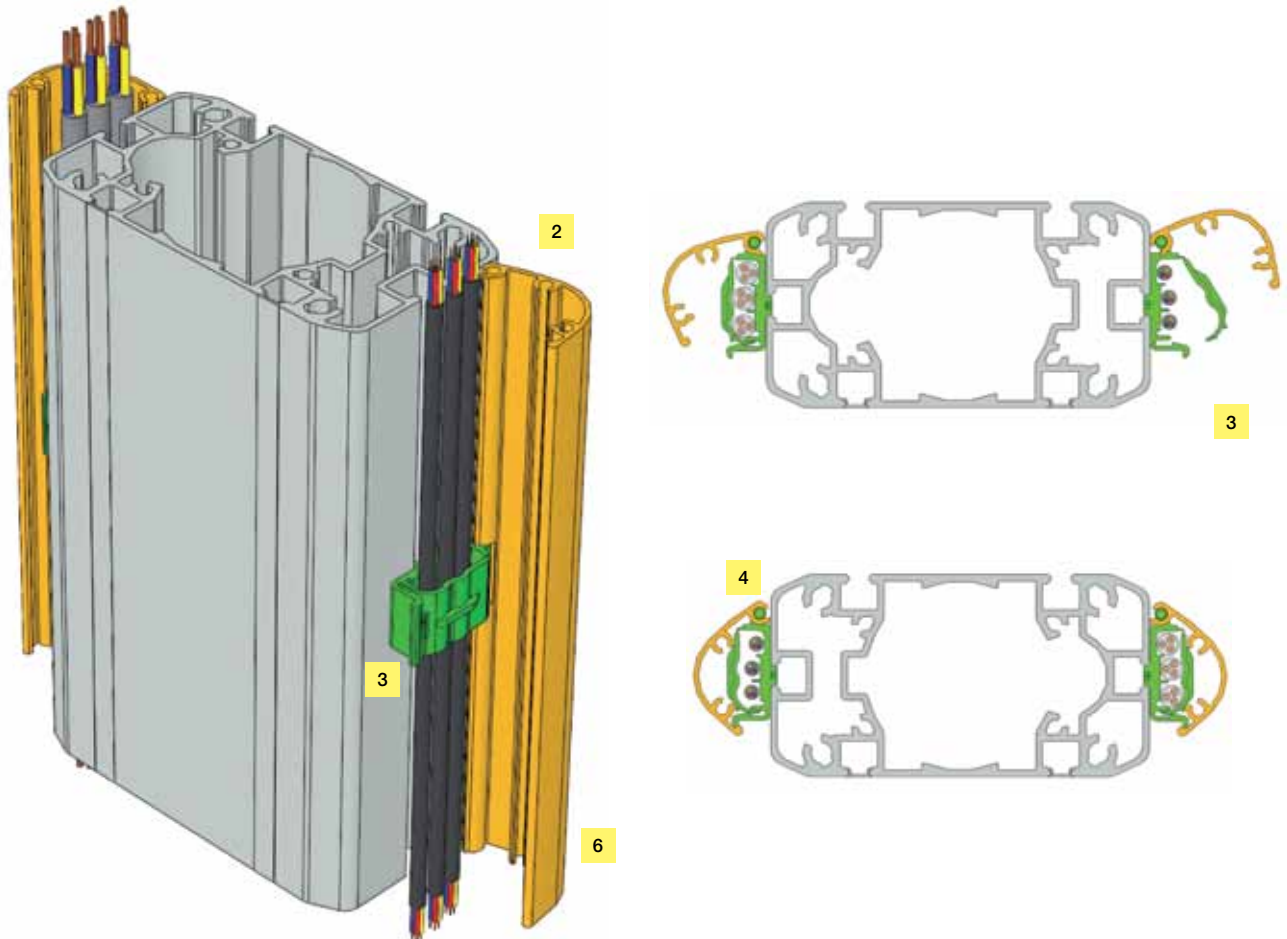

Cross-sectional view: the **vexio-cart** support extrusion with orderly cable routing in the ducts.

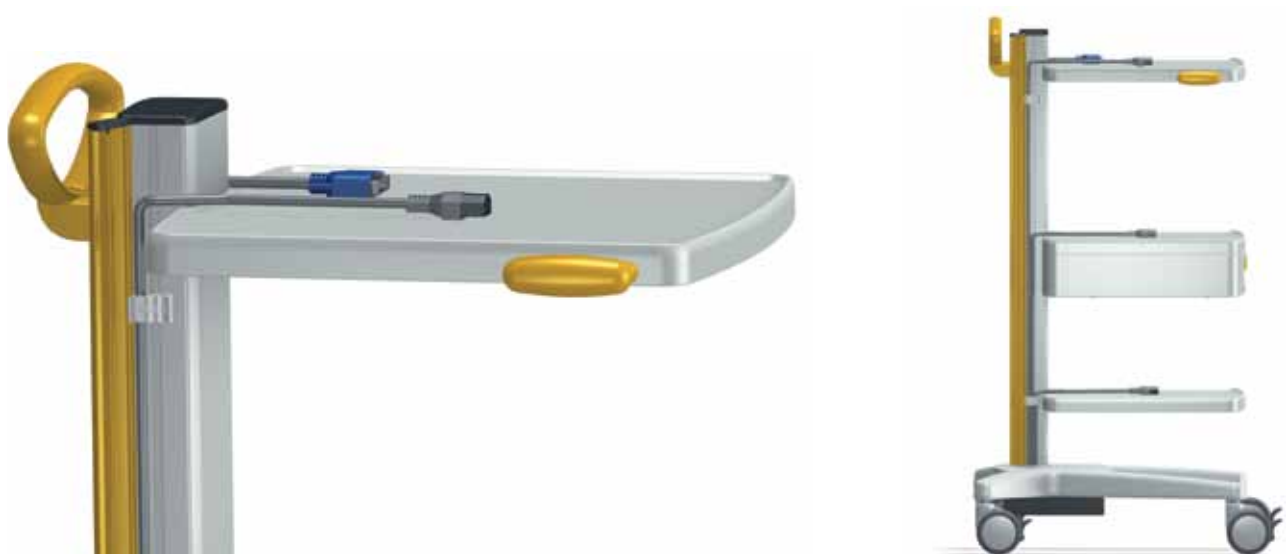

Orderly arranged in the duct, the cables are routed from the electrical box up to the desired location.

vexio-cart – NOVEL CABLE SOLUTION AND HYGIENE CONCEPT

The use of the **electrical box** provides a new **professional type of cabling** in the **vexio-cart** single-column equipment cart. The electrical box features are as follows:

- 1 The electrical box is fitted underneath the base to save space and provide easy access to the assembly points.
- 2 It offers a large storage space for different socket strips, power units, and excess cables.
- 3 The lock mechanism provides protection against unauthorised access (in accordance with the standard specifications).
- 4 It offers high pull-out ability and easy access in the event of a malfunction or the addition of further electrical components.
- 5 Easy wipe cleaning and disinfection options ensure compliance with the hygienic requirements in everyday hospital practice.
- 6 The POAG plug on the outside of the electrical box is used to connect the relevant cables.



The **vexio-cart** mobile equipment cart can be optionally equipped with an **electrical tray**:

- 7 The electrical tray is fitted beneath a shelf.
- 8 Large socket strips or residual cable volumes can be easily accommodated.
- 9 The opening slits at the rear of the electrical tray allow cable connection and excess options.

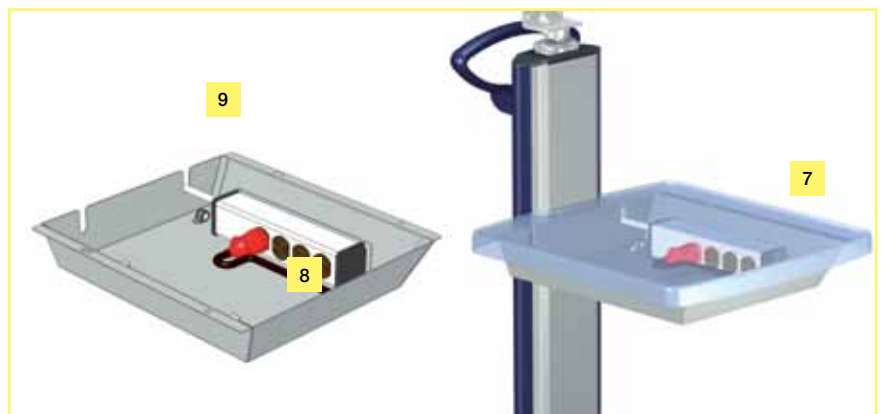
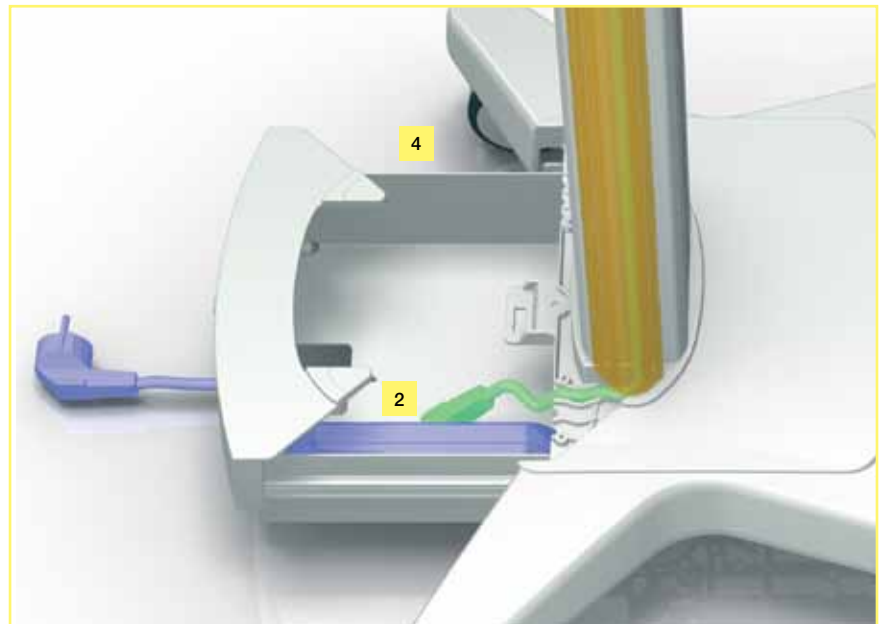

The **vexio-cart** meets and exceeds the inevitably rigorous hygienic requirements of surgery or hospital routine, as can be seen by the following points:

- 1 A simple wipe suffices to clean or disinfect its functional shapes and its smooth, powder-coated surfaces, e. g. in cable conduits or on bottom shelves.
- 2 Optionally available hygienic strips can be applied to the T-slots to cover and protect them.
- 3 Narrow slits thwart microbial build-up before it becomes a problem.

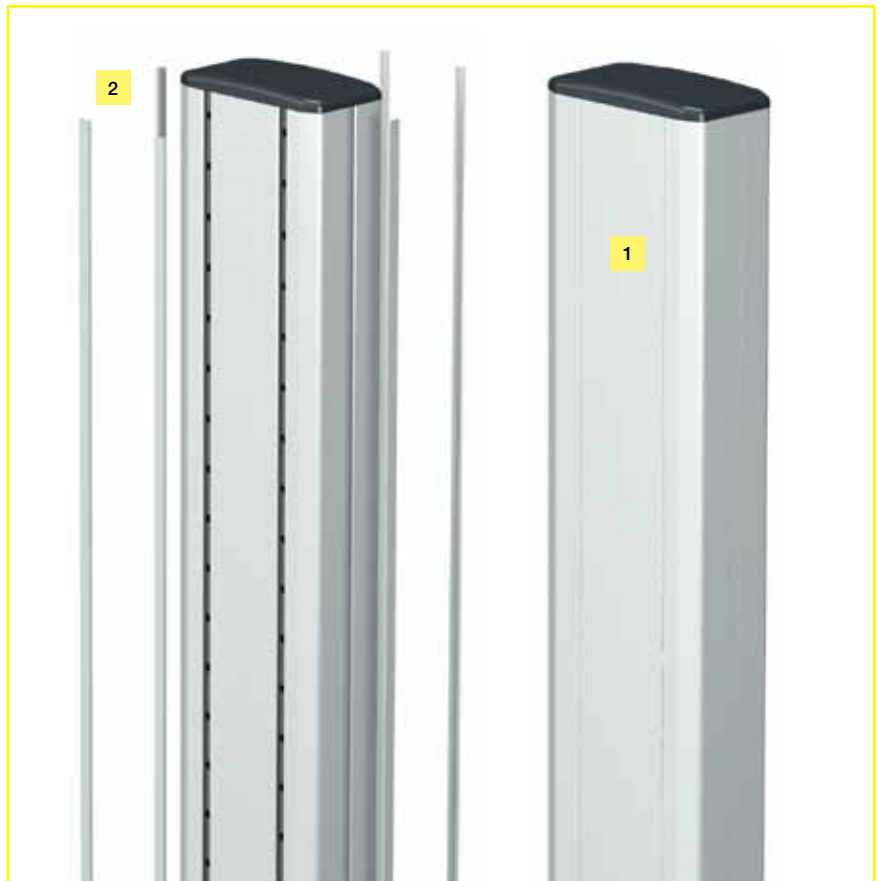
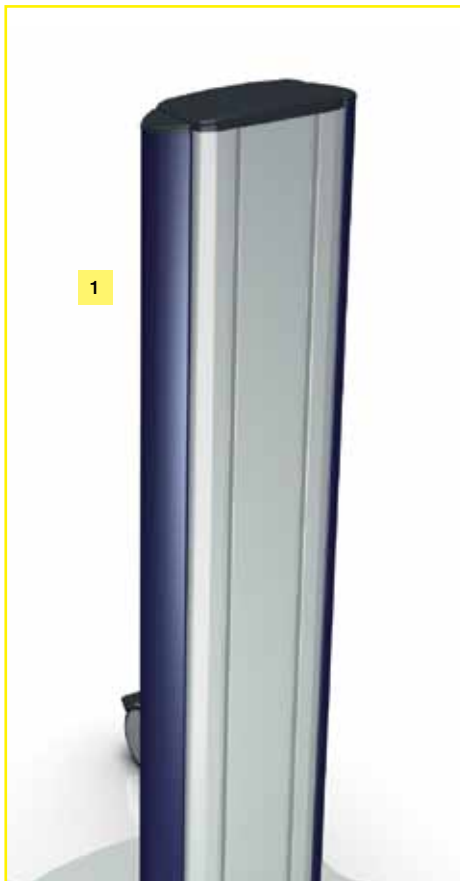
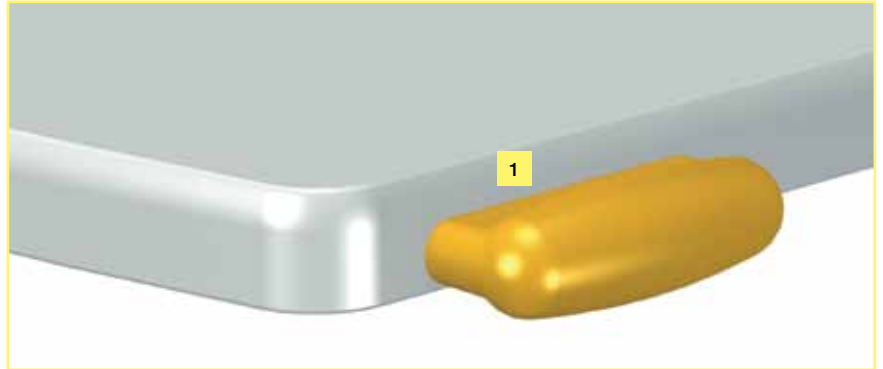

DESIGN ELEMENTS AND DIMENSIONS

- 1 Cap made of plastic (ABS)
- 2 Cap made of plastic (ABS) for covering the side-fed cable ducts
- 3 Tapped strip (made of steel, zinc-plated), for mounting all system components on the support column (tapped hole M6 in increments of 32 mm)
- 4 Cable ducts (made of extruded aluminium)
- 5 Support column (made of extruded aluminium)
- 6 Hygiene strips
- 7 Wiring conduits are held in place by braces that neatly route data and power feed lines
- 8 A base (made of aluminium) in RAL 7035 light grey, powder-coated
- 9 Twin swivel castors, lockable, with \varnothing 75 mm or \varnothing 100 mm, also supplied in conductive version
- 10 An electrical box (made of steel / ABS) for safe storage of power supply components, such as socket strips

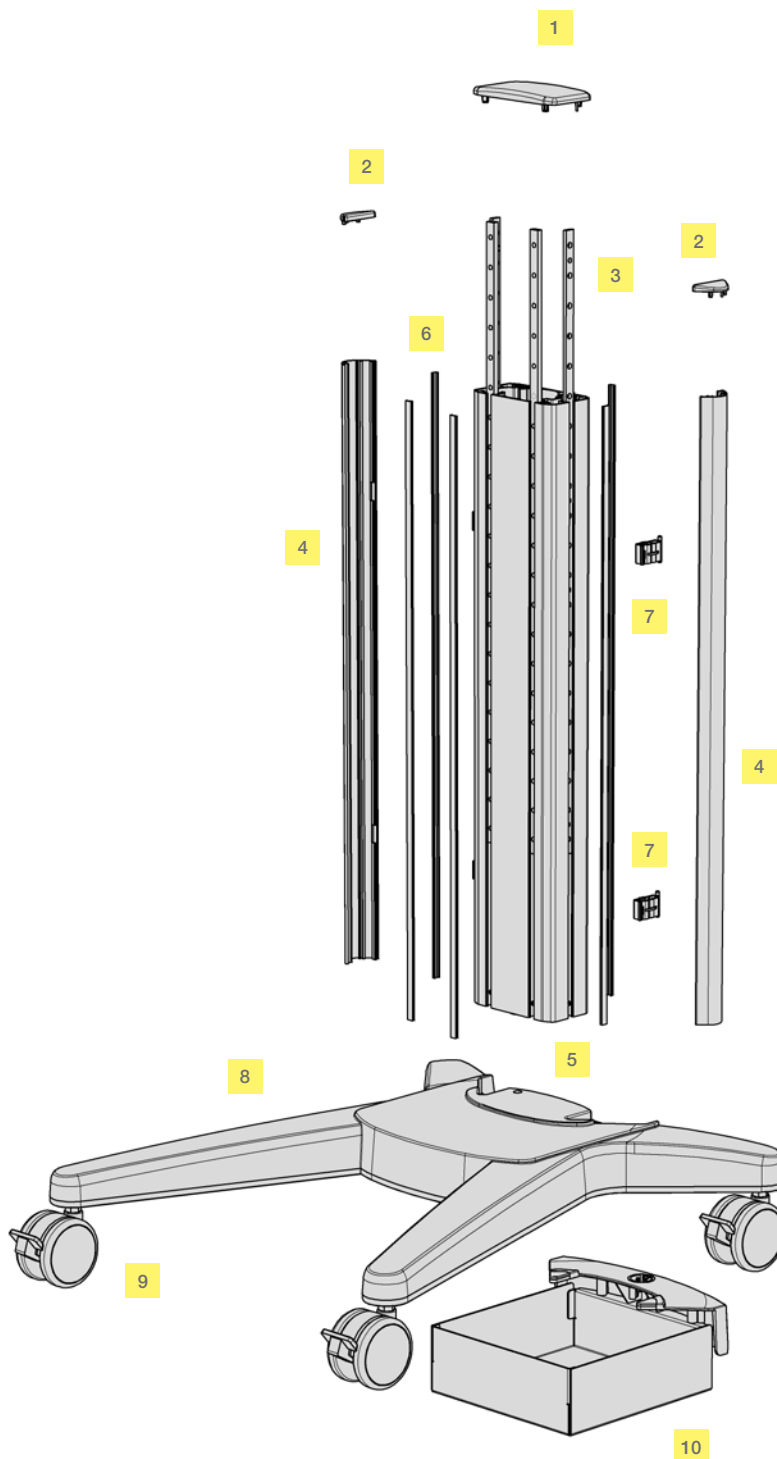

Setup basic frame

- 1 base
- 1 electrical box to accommodate electronic accessories („Profii“ version)
- 4 twin swivel castors with Ø 75 mm or Ø 100 mm (also supplied in a conductive version)
- 1 support column with 2 tapped strips for the entire height of the support extrusion
- 2 side-fed cable ducts with snap-open mechanism („Profii“ version)

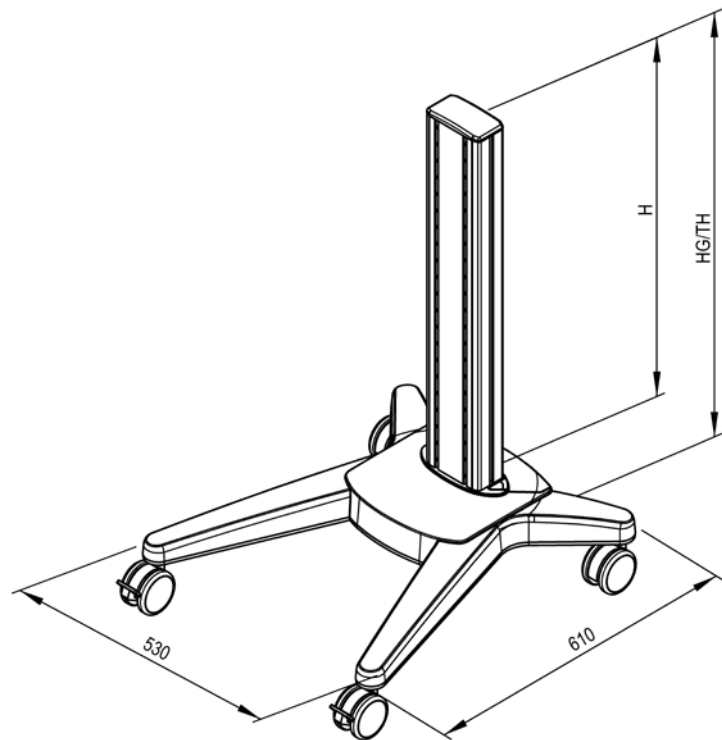

Length of the extrusion H	Installation height H (in units)	Total height TH for castors Ø 75 mm	Total height TH for castors Ø 100 mm
680 mm	21 U ¹⁾	830 mm	---
736 mm	23 U ^{1) 2)}	---	933 mm
800 mm	25 U ¹⁾	---	998 mm
960 mm	30 U ¹⁾	---	1160 mm

Load capacities

- Basic frame (total payload) 65 kg / 143 lbs
- Shelf 15 kg / 33 lbs
- Universal shelf 10 kg / 22 lbs
- Block of drawer
 - shelf 10 kg / 22 lbs
 - drawer 3 kg / 6.6 lbs
- Block of drawer, lockable 3 kg / 6.6 lbs
- Keyboard drawer 5 kg / 11 lbs

MODULARITY FOR NUMEROUS CONFIGURATION OPTIONS

The modular structure is the defining feature of the **vexio-cart** mobile single-column equipment carts and the entire ITD product range, which allows all support systems to be configured, customised, upgraded or easily modified for special functions and application areas using the extensive standard range. This capability allows users to react fast and consistently to any changes or new customer requirements. The T-slots on the support extrusion or special devices ensure easy assembly of the components. The display presented alongside shows a small selection of accessories for the **vexio-cart** equipment carts.

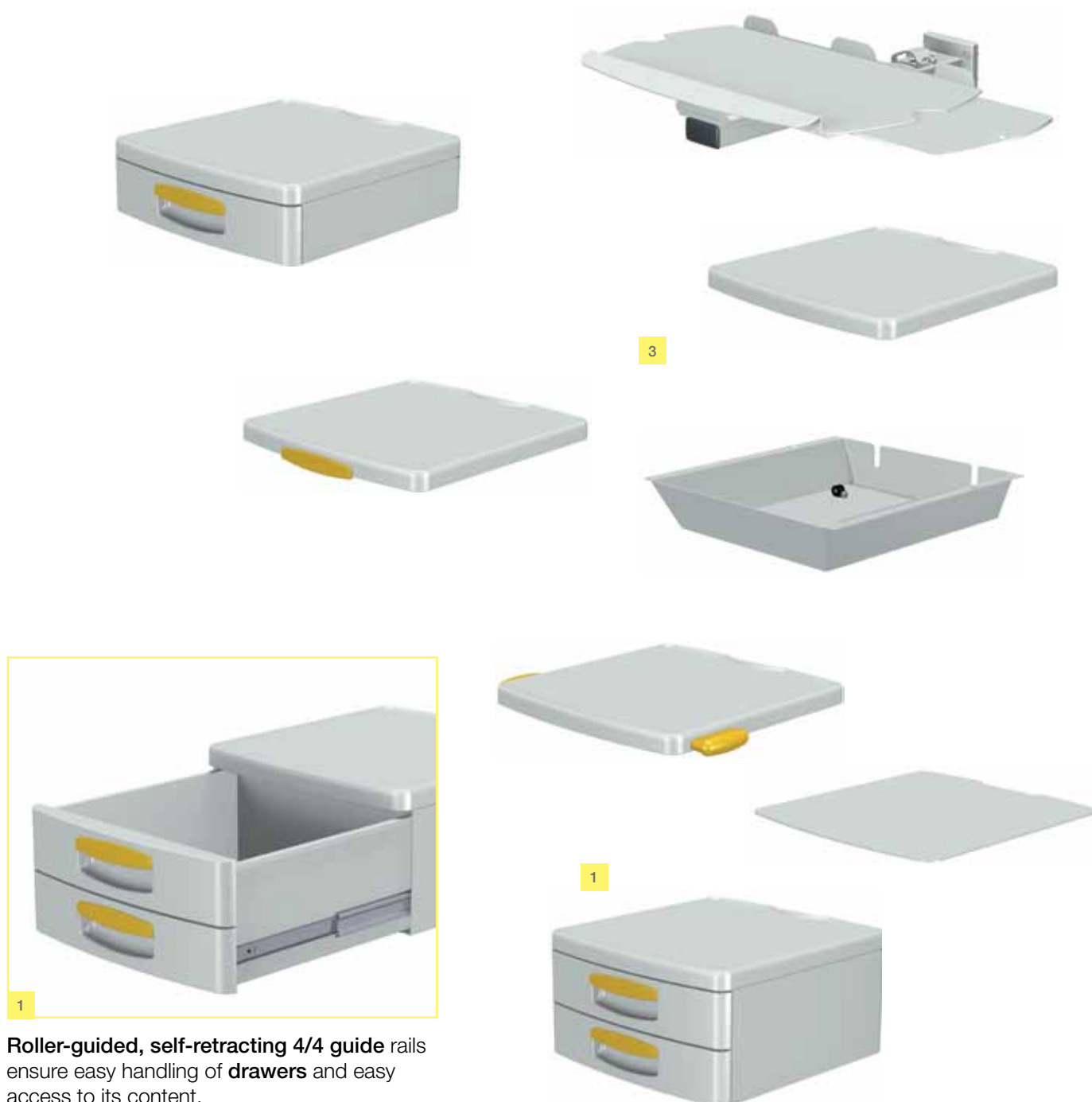

Roller-guided, self-retracting 4/4 guide rails ensure easy handling of **drawers** and easy access to its content.



A **variety of brackets** are available for installing monitors, to wit VESA 75 / 100 adaption, universal adapters or Quickmount units.



The **shelf** can be supplied in different versions and the continuous raised edge offers your valuable equipment a secure platform.



The **push handle** is held in a vertical position and can be used as a decorative element or a cable winder.

ORDER CONFIGURATIONS



vexio-cart basic cart

Order number: NT.5000.XXX ²⁾

Equipment cart, 21 U ¹⁾ (total height: 832 mm), fitted with:

- 1 basic frame with 4 twin swivel castors, lockable, Ø 75 mm
- 1 shelf
- 1 push handle, rear
- 2 hygiene strips, front

Load capacity: 65 kg / 143 lbs

Finish:

- RAL 7035 light grey, powder-coated
- **Handles und push handle** (see ²⁾)

vexio-cart laboratory cart

Order number: NT.5001.XXX ²⁾

Equipment cart, 21 U ¹⁾ (total height: 832 mm), fitted with:

- 1 basic frame with 4 twin swivel castors, lockable, Ø 75 mm
- 1 block of drawers, high, 2 units, with storage basket at the side
- 1 shelf
- 1 push handle, rear
- 2 hygiene strips, front

Load capacity: 65 kg / 143 lbs

Finish:

- RAL 7035 light grey, powder-coated
- **Handles und push handle** (see ²⁾)



vexio-cart ECG cart

Order number: NT.5002.XXX ²⁾

Equipment cart, 25 U ¹⁾ (total height: 998 mm), fitted with:

- 1 basic frame with 4 twin swivel castors, lockable, Ø 100 mm
- 1 electrical box in the equipment cart base
- 1 block of drawers with handles at the side
- 1 shelf, front
- 1 universal shelf
- 1 holder for suction system „Ergoline / Strässle“
- 1 push handle, rear
- 1 gel bottle holder
- 2 cable winders, rear
- 2 hygiene strips, front

Load capacity: 65 kg / 143 lbs

Finish:

- RAL 7035 light grey, powder-coated
- **Handles und push handle** (see ²⁾)

vexio-cart HF cart

Order number: NT.5003.XXX ²⁾

Equipment cart, 25 U ¹⁾ (total height: 998 mm), fitted with:

- 1 basic frame with 4 twin swivel castors, lockable, Ø 100 mm
- 1 block of drawers with storage basket at the side
- 1 universal shelf
- 1 foot switch cradle
- 1 push handle, rear
- 1 gas bottle holder, rear
- 2 cable winders, at the side
- 2 hygiene strips, front

Load capacity: 65 kg / 143 lbs

Finish:

- RAL 7035 light grey, powder-coated
- **Handles und push handle** (see ²⁾)

ORDER CONFIGURATIONS

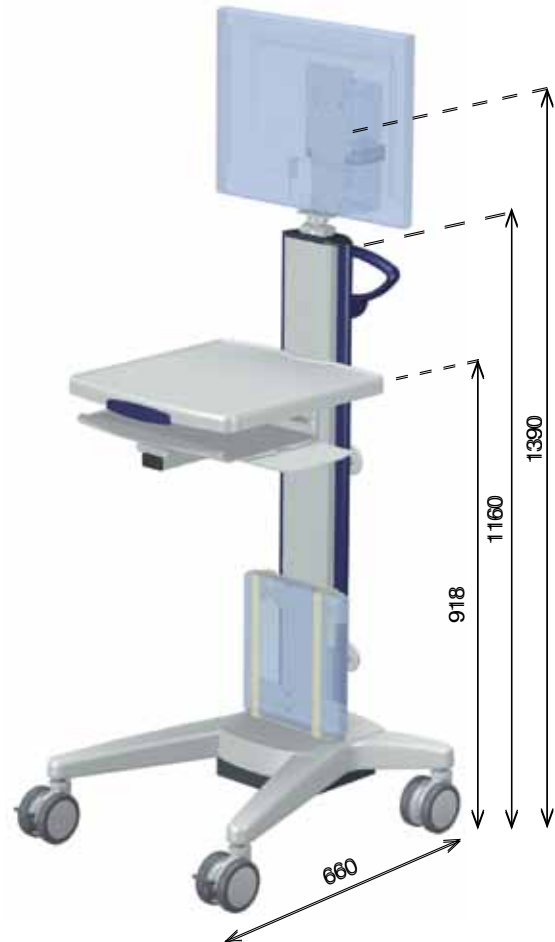

vexio-cart ergometry cart

Order number: NT.5004.XXX ²⁾

Equipment cart, 30 U ¹⁾ (total height: 1160 mm), fitted with:

- 1 basic frame with 4 twin swivel castors, lockable, Ø 100 mm
- 1 electrical box in the equipment cart base
- 1 shelf with handle, front
- 1 block of drawers, lockable
- 1 monitor holder, universal, with VESA 75 / 100 adaption up to 14 kg / 30.8 lbs
- 1 push handle, rear
- 1 EURO socket strip, 3-way, with external ground connection line
- 2 cable ducts, at the side
- 2 hygiene strips, front

Load capacity: 65 kg / 143 lbs

Finish:

- RAL 7035 light grey, powder-coated
- **Handles, cable ducts and push handle** (see ²⁾)

vexio-cart PC cart

Order number: NT.5005.XXX ²⁾

Equipment cart, 30 U ¹⁾ (total height: 1160 mm), fitted with:

- 1 basic frame with 4 twin swivel castors, lockable, Ø 100 mm
- 1 electrical box in the equipment cart base
- 1 shelf with handle, front
- 1 keyboard drawer with pull-out mousepad (left / right)
- 1 monitor holder, universal, with VESA 75 / 100 up to 14 kg / 30.8 lbs and power pack holder, small
- 1 computer holder, small
- 1 push handle, rear
- 1 EURO socket strip, 3-way, with external ground connection line
- 2 cable ducts, at the side
- 2 cable winders, rear
- 2 hygiene strips, front

Load capacity: 65 kg / 143 lbs

Finish:

- RAL 7035 light grey, powder-coated
- **Handles, cable ducts and push handle** (see ²⁾)

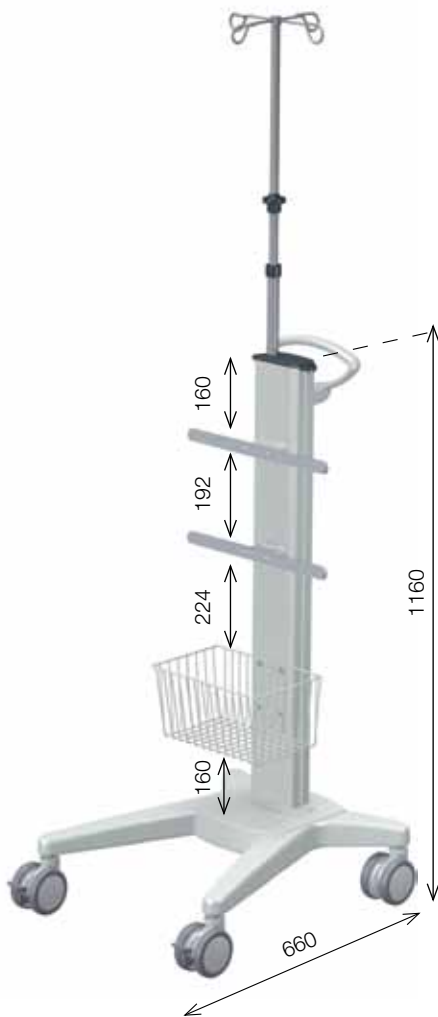

vexio-cart with IV pole

Order number: NT.5006.XXX ²⁾

Equipment cart, 30 U ¹⁾ (total height: 1160 mm), fitted with:

- 1 basic frame with 4 twin swivel castors, lockable, Ø 100 mm
- 2 standard runners (L 390 mm x D 10 mm x H 25 mm)
- 1 IV pole
- 1 storage basket, front
- 1 push handle, rear
- 1 IEC power transfer with cable harness, 3-way
- 1 POAG set with 3 leads
- 2 cable ducts, at the side
- 2 hygiene strips, front

Load capacity: 65 kg / 143 lbs

Finish:

- RAL 7035 light grey, powder-coated

vexio-cart with mechanical height adjustment

Order number: NT.5007.XXX ²⁾ (3-10 kg / 6.6-22 lbs)

NT.5008.XXX ²⁾ (8-14 kg / 17.6-30.8 lbs)

Equipment cart, 23 U ¹⁾ (total height: 933 mm), fitted with:

- 1 basic frame with 4 twin swivel castors, lockable, Ø 100 mm
- 1 electrical box in the equipment cart base
- 1 mechanical height adjustment (for a range of 300 mm)
- 1 release pedal for mechanical height adjustment
- 1 monitor holder, universal, with VESA 75 / 100 up to 14 kg / 30.8 lbs and keyboard holder with pull-out mousepad (left / right) as a unit
- 1 PC / computer holder, small
- 2 cable ducts, rear
- 2 hygiene strips, front

Load capacity: 65 kg / 143 lbs

Finish:

- RAL 7035 light grey, powder-coated
- Support column: anodized
- **Cable ducts** (see ²⁾)

OVERVIEW

SYSTEM COMPONENTS AND ACCESSORIES

Basic frame	basic version	Installation height 21 U ¹⁾ 25 U ¹⁾ 30 U ¹⁾	NT.4000.991 NT.4001.991 NT.4002.991
	„Profi“ version	Installation height 21 U ¹⁾ 25 U ¹⁾ 30 U ¹⁾	NT.4004.XXX ²⁾ NT.4005.XXX ²⁾ NT.4006.XXX ²⁾
Cable ducts		Installation height 21 U ¹⁾ 25 U ¹⁾ 30 U ¹⁾	NT.4112.XXX ²⁾ NT.4114.XXX ²⁾ NT.4115.XXX ²⁾
Hygiene strips		Installation height 21 U ¹⁾ 25 U ¹⁾ 30 U ¹⁾	NT.4128.991 NT.4129.991 NT.4130.991
Castor conversion kit	Ø 100 mm instead of standard Ø 75 mm Ø 100 mm, conductive, instead of standard Ø 75 mm Ø 100 mm, conductive, instead of standard Ø 100 mm Ø 125 mm, conductive, instead of standard Ø 100 mm wall protector		ZV.9716.999 ZV.9717.999 ZV.9428.999 ZV.9923.999 ZV.9964.999
Shelf	with handles at the side (left / right) with handle (front) with pull-out mousepad (left / right) with handle (front) and pull-out mousepad (left / right)		NT.4100.991 NT.4101.XXX ²⁾ NT.4102.XXX ²⁾ NT.4103.991 NT.4109.XXX ²⁾
Universal shelf			NT.4124.991
Keyboard holder	pull-out, with pull-out mousepad (left / right)		NT.4132.991
PC / Computer holder	small, up to 5 kg / 11 lbs large, up to 20 kg / 44 lbs		TS.6144.991 TS.6146.991
Power pack holder	universal, small universal, large		TS.0524.991 TS.0574.991
Laptop holder	with mousepad		TS.6301.991
Monitor holder	with VESA 75 / 100 adaption, universal, up to 14 kg / 30.8 lbs, in the support column with VESA 75 / 100 adaption, universal, up to 14 kg / 30.8 lbs, on the support column with universal adapter, up to 14 kg / 30.8 lbs, in the support column with Quickmount unit, up to 14 kg / 30.8 lbs, in the support column		NT.4117.991 TS.6359.991 NT.4133.991 NT.4134.991
Adapter plates	for Schiller Argus LCM for Nihon Kohden Life Scope for GE Critikon Pro, Dash, Datex Ohmeda for Nihon Kohden Life Scope BSM		TS.0360.999 TS.0576.999 TS.0305.999 TS.0670.999
Pivot arm	single, with VESA 75 / 100, up to 8 kg / 17.6 lbs		TS.6314.991
Counterweight kit			NT.4140.800
Drawer	lockable with pull-out mousepad (left / right) with handles at the side (left / right) 1 unit, high 1 unit, high, with handles at the side (left / right) 2 units, high 2 units, high, with handles at the side (left / right)		NT.4104.XXX ²⁾ NT.4105.XXX ²⁾ NT.4108.XXX ²⁾ NT.4118.XXX ²⁾ NT.4106.XXX ²⁾ NT.4119.XXX ²⁾ NT.4107.XXX ²⁾ NT.4120.XXX ²⁾
Storage basket	tapered stainless steel tapered, small		ZV.9967.800 ZV.9893.999 ZV.9892.991
Gel bottle holder			GW.0800.991
Gas bottle holder	for gas bottles with max. 2 l content for gas bottles with 3 / 5 / 10 l content, max. Ø 145 mm		GW.0466.991 GW.0160.991

IV pole	4 arm, with one-hand adjustment, 4 x 2 kg / 4 x 4.4 lbs	NT.4135.991
Standard runner	length 162 mm length 390 mm	RS.0132.991 RS.0076.991
Anchor	rigid with rotation unit	ZV.9820.799 TS.6286.991
Clamps	for standard runner, Ø 16 mm for standard runner, Ø 18 mm for shelf, Ø 16 mm for shelf, Ø 18 mm	ZV.9876.999 ZV.9877.999 ZV.9878.999 ZV.9879.999
Rail fastener		ZV.9957.999
Holder for suction system	für Ergoline / Strässle für Hellige / Kiss für custo med	NT.4125.991 NT.4126.991 NT.4127.991
Adapter pieces	Ø 16 mm (inside) Ø 18 mm (inside)	NT.4136.991 NT.4137.991
Foot switch cradle		ZV.9991.991
Equipment fixing		FC.0221.991
Box holder	„Dracula“	ZV.9832.999
Jointed arm	with hose clamps (Ø 16 mm) for small equipment (Ø 18 mm)	ZV.9955.799 ZV.9680.999
Push handle		NT.2000.XXX ²⁾
Socket strips	EURO, 3-way, with external ground connection cable earthed, 3-way British Standard, 4-way French Standard, 3-way, with external ground connection cable Swiss Standard, 3-way, with external ground connection cable US Standard, 4-way	ZV.9517.999 ZV.9516.999 ZV.9694.999 ZV.9397.999 ZV.9518.999 ZV.9525.999
Electrical box	lockable, with POAG connector	NT.4121.800
Electrical tray		NT.4123.991
Cable winder		FC.0253.991
EURO power cable	length 0,6 m length 1,0 m length 1,5 m length 2,0 m length 2,5 m	ZV.9773.799 ZV.9960.799 ZV.9371.799 ZV.9372.799 ZV.9373.799
Adapter cable	length 0,3 m	ZV.9959.799
IEC power transfer	with cable harness, 3-way	ZV.9572.999
POAG set	with socket and leads (for vexio-cart basic version) with leads (for vexio-cart „Profi“)	ZV.9573.999 ZV.9574.999

You will find a comprehensive description and ordering information on all components in the „**system components and accessories**“ section.

System components and accessories

from page 132

Order number index

from page 262



²⁾ Trim colour: make sure you replace .XXX with .902 = RAL 5013 cobalt blue, .903 = RAL 7035 light grey, .908 = RAL 5015 sky blue, .909 = RAL 1033 signal yellow